

## Suction Plates SUF

Suction area (Ø) from 125 mm to 210 mm

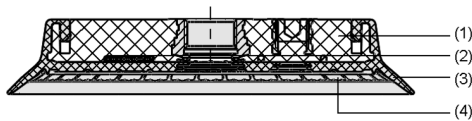

Suction Plates SUF



System design Suction Plates SUF

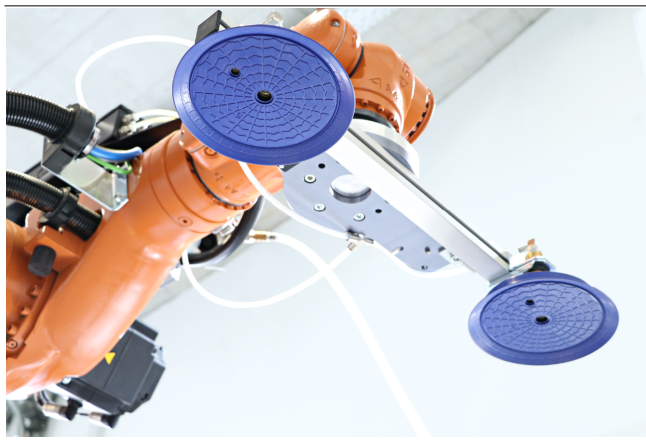

Suction plates SUF for handling glass plates

### Suitability for industry specific applications

#### Application

- Round suction plate for handling of flat, smooth workpieces such as sheet metal, plastic, coated timber, granite or concrete
- For universal use in handling processes in vacuum automation and with manual vacuum lifting devices
- Use in processes requiring high suction forces or acceleration
- Use in dirty environmental conditions such as oil
- Handling thin-walled workpieces such as thin metal sheets

#### Design

- Reinforced plastic supporting plate (1)
- Integrated NFC-interface (2)
- Replaceable sealing ring (3) with special friction structure (4) and optimized sealing edge

#### Product highlights

- Weight reduction by 30 % due to a carrier plate made of reinforced plastic
- Sealing ring made of oil and ozone-resistant NBR with optimised friction structure for increased suction and lateral force
- Innovative connection between supporting plate and sealing ring simplifies replacement and protects against twisting
- Read out product information via NFC interface with the smartphone and carry out replacement procurement

## Suction Plates SUF

Suction area (Ø) from 125 mm to 210 mm

### Designation code Suction Plates SUF

<b>SUF</b>	–	<b>210</b>	–	<b>NBR-60</b>	–	<b>G1/2-IG</b>	–	<b>VRS</b>
1		2		3		4		5

1 – Abbreviated designation		2 – Suction area		3 – Material	
Code	Version	Code	Diameter in mm	Code	Material
SUF	Flat	125...210	ø 125 to 210	NBR-60	Nitrile cautchuc

4 – Connection		5 – Product addition	
Code	Connection	Code	Connection
G1/4-IG	G1/4-IG	VRS	Screw plug
G1/2-IG	G1/2-IG		







Suction plate SUF (sealing ring + support plate) is delivered pre-assembled. The product consists of:

- Sealing ring of type DR-SUF – elastomer part, available in various diameters
- Reinforced plastic support plate with various threads

Available spare parts: sealing ring DR-SUF

Available accessories: touch valve TV, screen

### Ordering data Suction Plates SUF

Type	Part no.
SUF 125 NBR-60 G1/4-IG	10.01.01.14521 
SUF 125 NBR-60 G1/4-IG VRS	10.01.01.14316 
SUF 160 NBR-60 G1/2-IG	10.01.01.14522 
SUF 160 NBR-60 G1/2-IG VRS	10.01.01.14330 
SUF 210 NBR-60 G1/2-IG	10.01.01.14523 
SUF 210 NBR-60 G1/2-IG VRS	10.01.01.13536 

### Ordering data Spare parts Suction Plates SUF

Type	Spare parts	Part no.
SUF 125	Sealing ring for SUF suction plate	DR-SUF 125 NBR-60 10.01.01.14319
SUF 160	Sealing ring for SUF suction plate	DR-SUF 160 NBR-60 10.01.01.14327
SUF 210	Sealing ring for SUF suction plate	DR-SUF 210 NBR-60 10.01.01.13846

### Ordering data Accessories Suction Plates SUF

Type	Accessories	Part no.
SUF 125 NBR-60 G1/4-IG	Sieve, round	SIEB 15x0.8 MS-A2 0.103/0.07 10.07.01.00211
SUF 125 NBR-60 G1/4-IG VRS	Sieve, round	SIEB 15x0.8 MS-A2 0.103/0.07 10.07.01.00211
SUF 160 NBR-60 G1/2-IG	Sieve, round	SIEB 27x1 MS-A2 100 100/65 10.07.01.00110
SUF 160 NBR-60 G1/2-IG VRS	Sieve, round	SIEB 27x1 MS-A2 100 100/65 10.07.01.00110
SUF 210 NBR-60 G1/2-IG	Sieve, round	SIEB 27x1 MS-A2 100 100/65 10.07.01.00110
SUF 210 NBR-60 G1/2-IG VRS	Sieve, round	SIEB 27x1 MS-A2 100 100/65 10.07.01.00110

Type	Accessories	Part no.
SUF 125	Touch Valve	TV G1/8-AG 10 10.05.10.00088
SUF 160	Touch Valve	TV G1/4-AG 12 10.05.10.00086
SUF 210	Touch Valve	TV G1/4-AG 12 10.05.10.00086

## Suction Plates SUF

Suction area (Ø) from 125 mm to 210 mm

### Technical data Suction Plates SUF

Type		Suction force (-600 mbar) [N]*	Suction force d2 [N]**	Volume [cm³]	Workpiece radius min. (convex) [mm]
SUF	125	730	450	96	250
SUF	160	1,200	790	176	400
SUF	210	2,070	1,400	362	750

\*The specified suction forces are theoretical values at a vacuum of -0.6 bar and with a smooth, dry workpiece surface - they do not include a safety factor

\*\*Suction force referred to the sealing-edge diameter d2

## Suction Plates SUF

Suction area ( $\emptyset$ ) from 125 mm to 210 mm

### Design data Suction Plates SUF

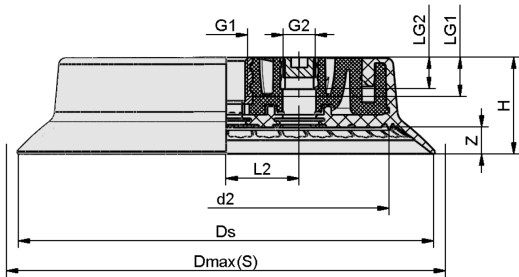

SUF 125

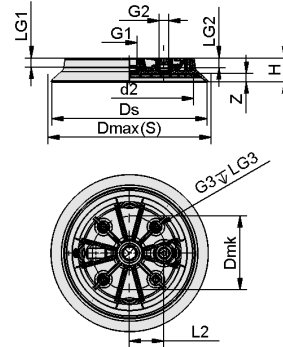

SUF 160 - 210

## Suction Plates SUF

Suction area (Ø) from 125 mm to 210 mm

### Design data Suction Plates SUF

Type		d2 [mm]	Dmax(S) [mm]	Dmk [mm]	Ds [mm]	G1	G2		H [mm]	L2 [mm]	LG1 [mm]	LG2 [mm]	LG3 [mm]	Z [mm]
SUF	125	98.0	132	-	125	G1/4"-F	G1/8"-F	-	29	22.0	11.8	9.5	-	8
SUF	160	130.0	170	66.5	160	G1/2"-F	G1/4"-F	M8-F	30	32.5	14.0	11.8	11.1	9
SUF	210	172.9	220	100.0	210	G1/2"-F	G1/4"-F	M8-F	32	46.5	12.2	11.8	11.1	11

### Multimedia product presentation

Medium	Link
Product video	<a href="https://vimeo.com/380455243">https://vimeo.com/380455243</a>